

TECHNICAL DATA

	METRIC	IMPERIAL
Dimensions	1156 x 546 mm	3' - 9' 1/2" x 1' - 9' 1/2"
Panel Height	51	2"
Adjustable Leg Height	6 - 45 mm	1/4" - 1 3/4"
Product Weight	10 kg/m ²	2 lbs/sqft
Uniform Load	4.8 kPa	100 lbs/sqft
Point Load	9.0 kN (0.75 x 0.75 m area)	2000 lbs (30" x 30" area)
Thermal Conductivity	R-Value 10	U-Value 0.1

*All testing was conducted with 5/8" tongue and groove plywood on top of the Fatti Track panel.

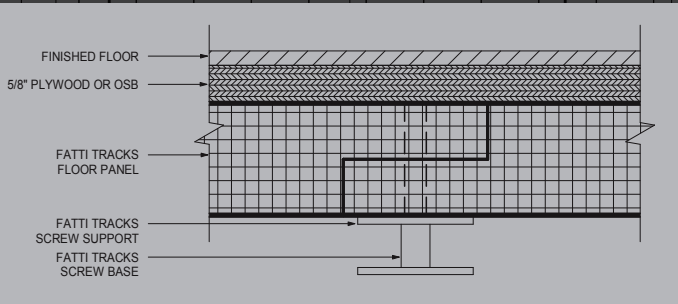

CONTACT US

Fatti Tracks
1080 Brock Rd. Unit 9
Pickering, Ontario
L1W 3X4

tel: 647-520-2169
email: Info@fattitracks.com
web: Fattitracks.com



GET ELEVATED

THE FUTURE OF SUBFLOORING



OUR SYSTEM

Fatti Tracks is a raised insulated subfloor with adjustable legs that allows flooring to be elevated from cold, wet floors below.

The panels are made of rigid insulation with graphite mesh and a thin cement coating. The construction of the panel allows for a light, insulated, water resistant design. The adjustable legs are made of steel and can be coated in zinc if exposed to wet conditions.

APPLICATIONS

Upper floors
Basements
Roofs
Exterior Terraces

BENEFITS

Light – Our panel assembly adds only a nominal weight load increase on floors.

Adjustable – Each panel can be customized to create a level surface on uneven floors.

Dry – Made from water resistant material which allows for drainage below keeping the surface above dry.

Functional – Wires, cables and pipes can be installed to run below the system.

Quiet – Reduces sound and impact transmission between floors and prevents disturbing occupants below.

Comfortable – Insulating properties help maintain your ideal temperature.

Safe – Mold and corrosion resistant.

